

Specification

Connectors	Input	Standard with	HDMI In/Loop	2×HDMI-A	VGA	1×DB15
			DVI	1×DVI-I	CVBS	1×BNC
		1 specific slot up to 1 SDI input Select from	SDI In/Loop	2×BNC(1 In 1 Loop)		
	Audio	1 slot up to 1 input Select from	DVI Module	1×DVI-I (DVI,VGA, YPbPr, CVBS)	3G SDI Module	2×BNC (1 In 1 Loop)
			HDMI Module	2×HDMI-A (1 In 1 Loop)	USB Module	2×USB-A (1 In 1 Backup)
			CVBS	2×BNC (1 In 1 Backup)	HDBaseT Module	1×RJ45
	IN L/R	2×RCA				
	OUT L/R	2×RCA				
	Audio Out	1×3.5mm Stereo Jack				
Output		DVI	2×DVI-I			
Communication		Serial RS232 In	1×RJ11			
		Serial USB In	1×USB-B			
Power			1×IEC			
Performance	Input Resolutions	DVI   HDMI	480i   576i   720p@50/59.94/60   1080i@50/59.94/60   1080p@50/59.94/60			
		SMPTE	800×600@60   1024×768@60   1280×768@60   1280×1024@60   1366×768@60   1600×1200@60   1920×1080@60			
	VESA	800×600@60   1024×768@60   1280×1024@60   1366×768@60   1440×900@60   1600×1200@60   1920×1080@60				
	VGA	800×600@60   1024×768@60   1280×1024@60   1366×768@60   1440×900@60   1600×1200@60   1920×1080@60				
Output Resolutions	SDI	480i   576i   720p@25/30/50/60Hz   1080i@50/59.94/60Hz   1080p@23.98/24/25/29.97/30/50/59.94/60Hz				
	SMPTE	Select from below or configure customized				
Supported Standard	DVI	720p@50/60   1080p@50/60				
	SMPTE	1024×768@60   1280×720@60   1280×800@60   1280×1024@60   1360×768@60   1366×768@60   1440×900@60   1400×1050@60   1600×1200@60   1680×1050@60   1920×1080@60   1920×1200@60   2048×1152@60   2560×816@60				
	VESA	SMPTE 425M (Level A & B)   SMPTE 424M   SMPTE 292M   SMPTE 259M-C   DVB-ASI				
Power	Input Voltage	AC 100~240V, 50/60Hz				
	Max Power	25W				
	Temperature	0°C~55°C				
Environment	Humidity	10%~90%				
	Weight	Net (Device)	3.1kg			
Physical		Packaged	5.25kg			
	Dimension	Net (Device)	480mm×303mm×45mm			
		Packaged	540mm×360mm×135mm			

Order Codes

Product Code	Item
820-1004-04-0	X1Gpro
190-0001-02-2	Single VGA Input Module
190-0001-04-1	Single DVI Input Module
190-0001-07-4	Single 3G SDI Input/Loop Module
190-0001-09-2	Single CVBSInput/Backup Module
190-0004-03-0	Single HDMI Input/Loop Module
190-0004-05-0	Single HDBaseT Input Module
190-0004-08-0	Single SDI Input/Loop Module
880-0033-01-0	SubitoNX Quatro Sender Module

Dimensions

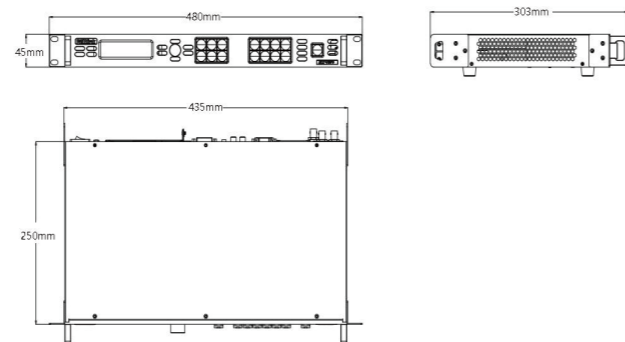

HDMI® HDCP™

WEB: www.rgblink.com EMAIL: sales@rgblink.com PHONE: +86 592 5771197  
Proudly designed and manufactured in Xiamen Hi Technology Zone, China

**RGBlink**®



www.rgblink.com



X1Gpro

All in one video processor

**RGBlink**®



# X1Gpro



X1Gpro is a 2K-level LED screen display and control integrated processor. X1Gpro provides 1 optional input module and 1 SDI module to meet the needs of different engineering projects. In some municipal engineering fixed installation projects, X1Gpro provides a pair of audio inputs, which can realize audio and video synchronization switching display.

## Features

- Picture-in-Picture (PIP)
- Transition effects
- RGBlink instant TAKE with pre-Sync
- Audio controls
- Support for RGBlink OpenAPI
- On board test patterns
- Support for multi-device cascade
- Support for additional input options
- EDID management on board

## Transition Effects

A range of transition effects are including, allowing different effects when switching between inputs signals.

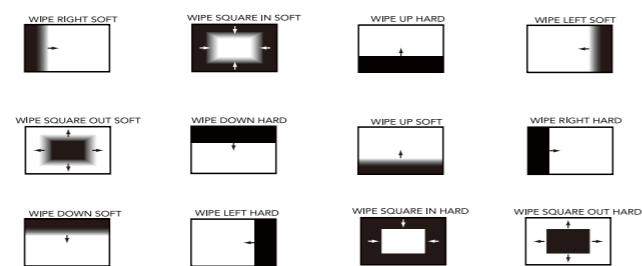

## Multi-Device Splicing

Combine multiple devices linking via HDMI to provide pixel perfect video for splicing multiple displays.

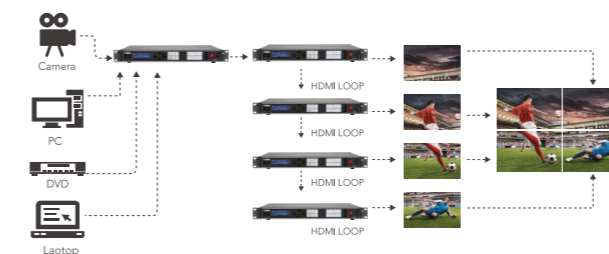

## Input modular option

In addition to the standard input interface, you can also choose any one input, including SDI, HDMI, HDMI IN/LOOP, USB, HDBaseT, DVI (compatible with CVBS, VGA, YpbPr).

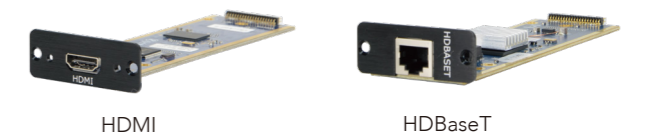
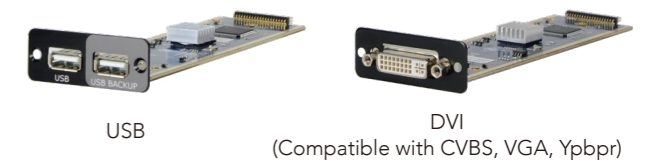

## Audio Integrated

X1Gpro supports both embedded and insert audio with both external output and embedded transmission. The RCA audio output is ideal for de-embedded audio to be connected to dedicated audio systems, while the embedded audio is idea for transmission of audio together with video to remote LED displays that contain speakers such as in digital signage applications. Integrated audio capabilities on X1Gpro adds to the processors capabilities as a complete solution.



## Seamless Switching

X1Gpro supports seamless switching between any in and any out, and supports TAKE pre-sync for delay free switching and signal confirmation before switch the input signal source.

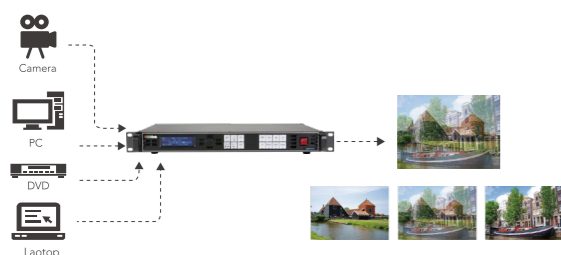

## Picture-by-Picture display

Select any input signal for use as a PIP our configure sources side-by-side as PBP (picture-by-picture) for area of interest display for specific displays. Menu functionally provides quick presets as well as refinements.

